

EMTB

EMTB Y

EMTB V

Solid-liquid mixer



EMTB solid-liquid mixers, with the optimised design of the blade and suction system, produce completely homogenised mixtures of powders or granulated products with liquids. The simplicity of the parts and the connections system facilitate maintenance tasks and ensure highly hygienic operation conditions.

The main fluid is pumped and carried through the mixing chamber, creating the suction required in order to add the solid, which is mixed violently to produce dissolution. Once all the powder is added, the regulation valve is closed and, after several circulations, a completely homogenised mixture is obtained. This solid incorporation system prevents product moistening, thickening and solidification, thus avoiding any operation problems resulting from the appearance of agglomerations in the load.

EMTB performance makes them ideal for working in the foodstuff, cosmetic and pharmaceuticals industries. Some examples of operations where EMTB mixers are used are as follows:

- Brine preparation
- Reconstitution of powdered milk
- Syrup production
- Dissolution of bentonite, thickeners, sugar, etc.
- Incorporation of preservatives, additives, agrochemical products, lime, etc.

MODELS

EMTB 2.2 - 3000

EMTB 4 - 3000

EMTB 7.5 - 3000

CARACTERISTICS

Single mechanical seal S/S/EPDM

Level of finish: Sanitary

High hygiene degree

Quick dismantling with clamp connections

Manual butterfly valve

External protection against environmental oxidation

MATERIALS

The parts in contact with the product are made from polished stainless steel AISI 316L

Platform and cover in AISI 304

EPDM gaskets

OPTIONS

Pneumatic actuator valve

Ball valve

Level probes

Gaskets in other materials

Dual mechanical seal

Centrifugal feeder pump

Positive displacement feeder pump

Vibrators

Control panel

Trolley, platform

DIMENSIONS OF THE EMTB H MODEL

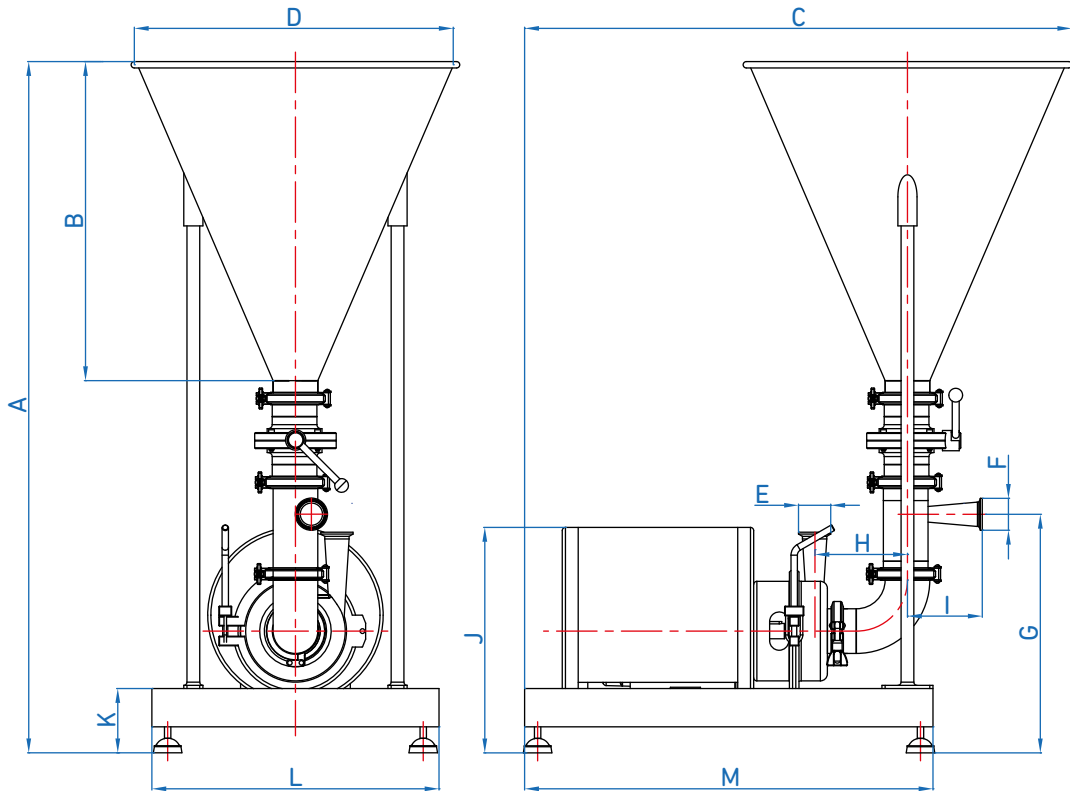

OVERALL DIMENSIONS

MODEL	Pow. (kW)	A	B	C	D	E	F	G	H	I	J	K	L	M
EMTB 2.2-3000	2.2	1078	500	954	500	DN40	DN40	395	145	120	350	110	400	640
EMTB 4-3000	4	1100	500	954	500	DN50	DN40	417	145	120	410	110	400	640
EMTB 7.5-3000	7.5	1328	500	1158	700	DN65	DN50	636	124	120	575	160	500	1000

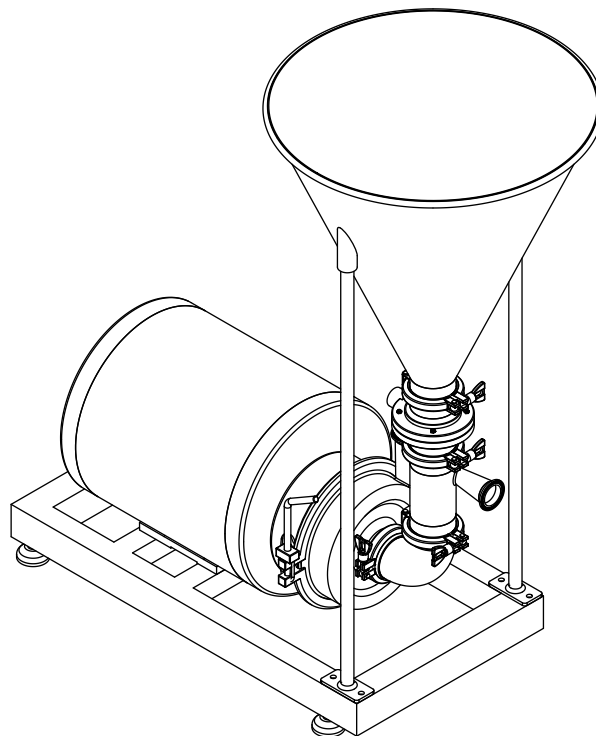

DIMENSIONS OF THE EMTB Y MODEL

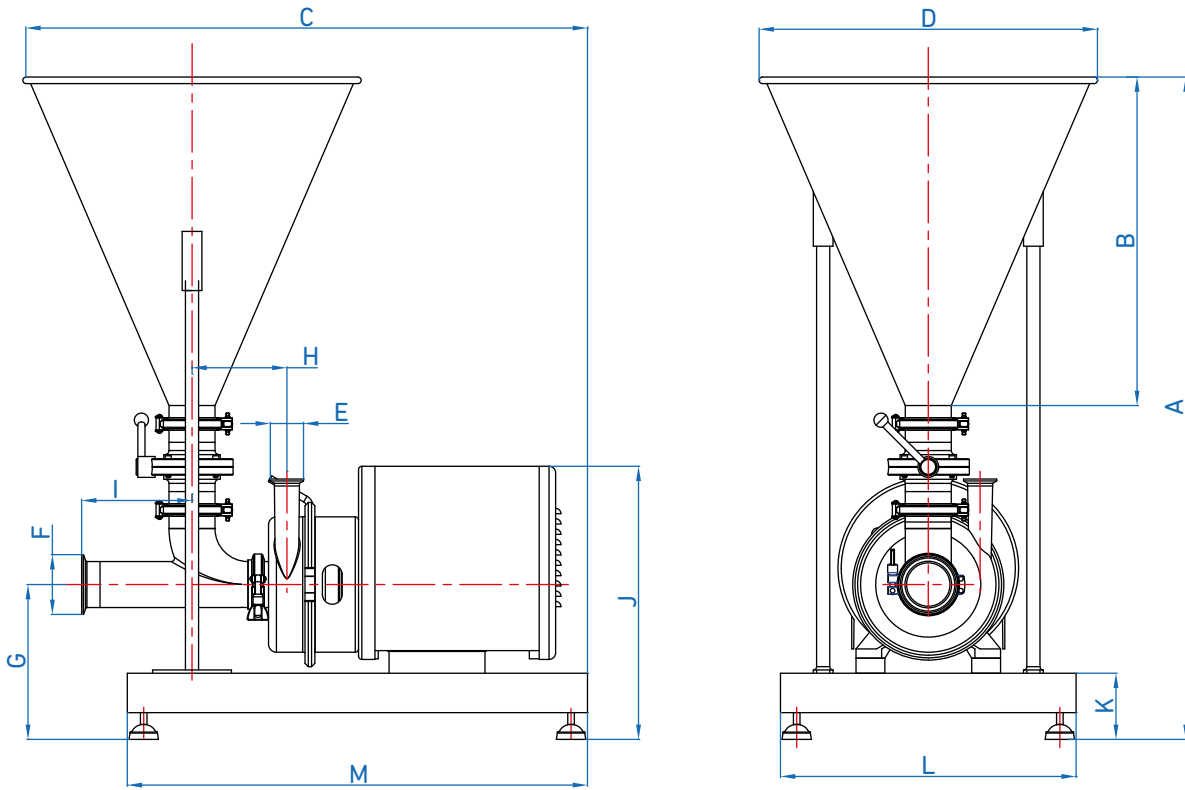

OVERALL DIMENSIONS

MODEL	Pow (kW)	A	B	C	D	E	F	G	H	I	J	K	L	M
EMTB Y 2.2-3000	2.2	980	500	955	500	DN50	DN40	395	145	120	350	110	400	640
EMTB Y 4-3000	4	1000	500	955	500	DN65	DN50	417	145	120	410	110	400	640
EMTB Y 7.5-3000	7.5	1050	500	1160	700	DN80	DN65	636	270	170	575	160	500	1000

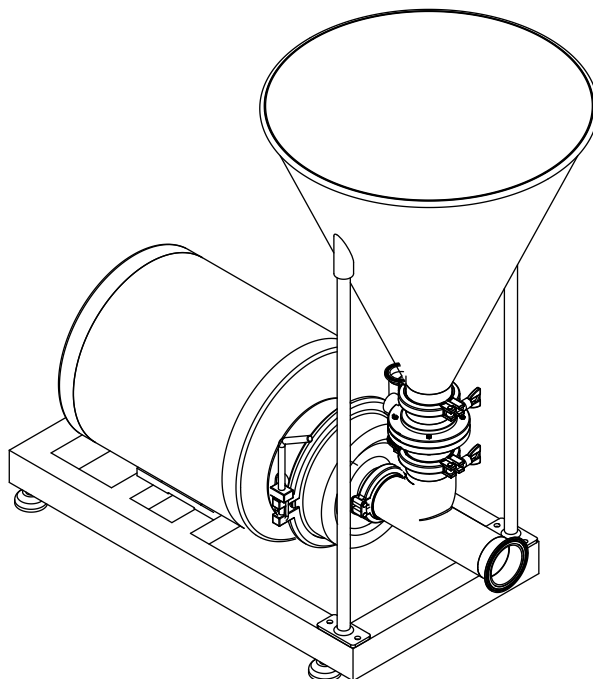

DIMENSIONS OF THE EMTB V MODEL

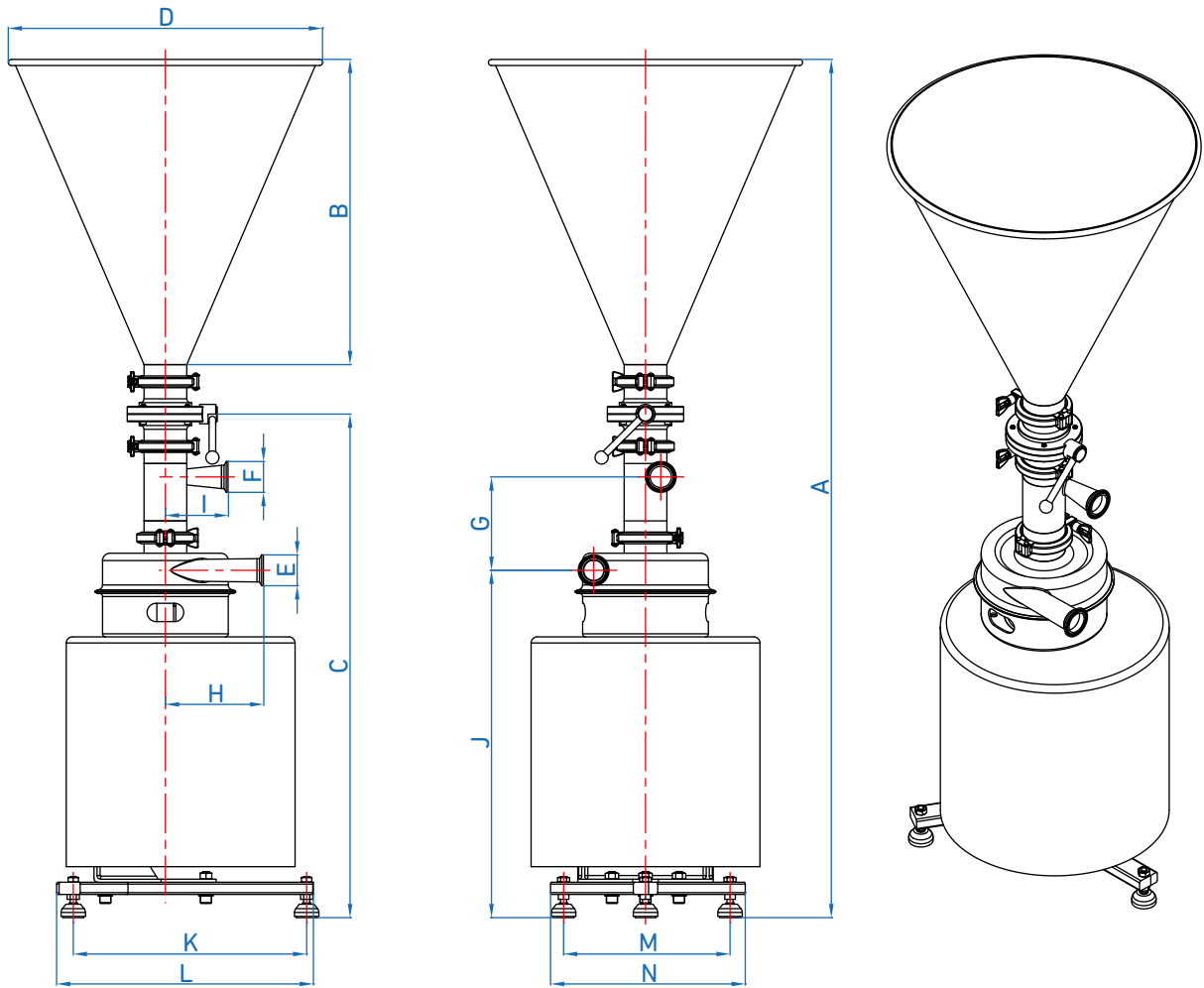

OVERALL DIMENSIONS

MODEL	Pow. (kW)	A	B	C	D	E	F	G	H	I	J	K	L	M	N
EMTB V 2.2-3000	2.2	1370	500	795.5	500	DN50	DN40	138	145	120	521	380	420	273	320
EMTB V 4-3000	4	1430.5	500	836	500	DN50	DN40	141	179.5	120	579	380	420	273	320